

Lumaire Sample Kits

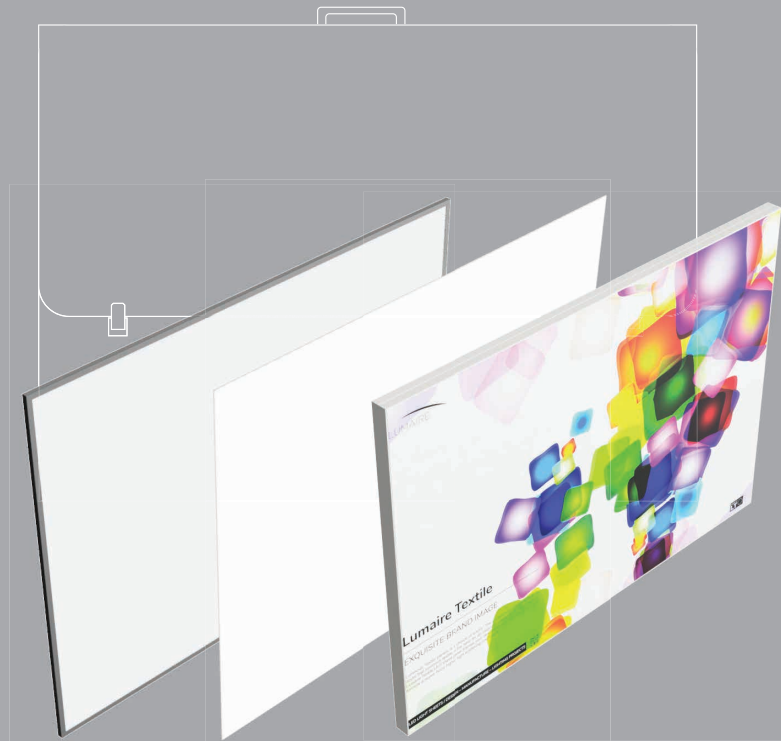

SAMPLE KIT Nr 1.

Basic Led panel
700 x 500mm

Opal (Milky) front cover
700 x 500mm

SAMPLE KIT Nr 2.

Textile Led panel
700 x 500mm



SAMPLE KIT Nr 3.

Magnetic Led panel
700 x 500mm

SAMPLE KIT Nr 4.

Wayfinding. Opal. PVC print
700 x 500mm

SAMPLE KIT Nr 5.

Magnetic Led panel
500 x 700mm

SAMPLE KIT Nr 1. Basic LED panel

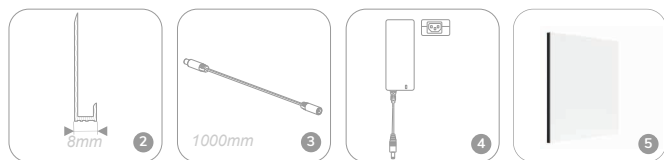
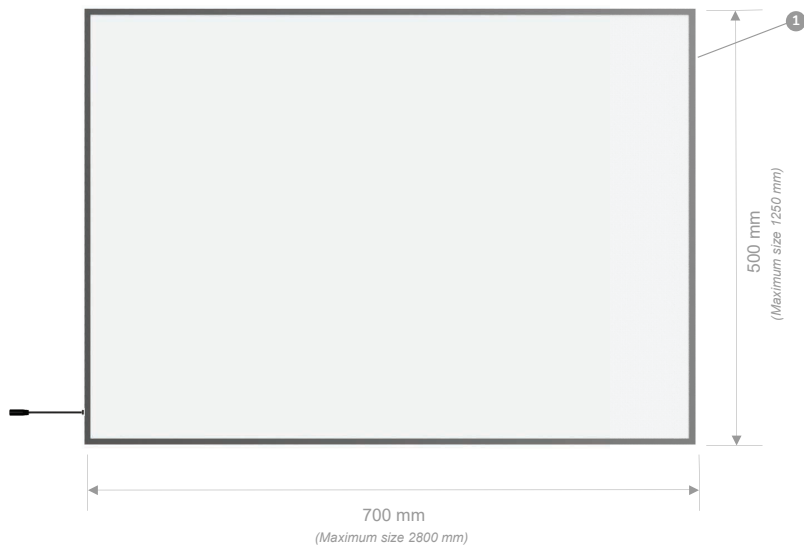

Lumaire Basic



SAMPLE KIT INCLUDE:

- 1• Sample Kit - Basic LED panel. Single sided. Dimensions: 500 x 700mm
- 2• Aluminium frame. Thickness is just 8mm
- 3• Power supply - silver cable 1000mm
- 4• Power supply - DC 12V / 24V / CC Adaptor
- 5• OPAL (Milky) front cover 2mm

Ultra-thin led sheet Lumaire Basic radiates class. The thinnest LED panel in the market is of 8 mm thickness only. These acrylic light panels scatter the light to perfection, making it irresistible to take the eyes off of the lighting solution. Different design options enable custom application. Perfectly simple customization reveals limitless possibilities to emphasize your individuality.

SUPPORT 24/7, PROTECTION & WARRANTY

SAMPLE KIT Nr 2. Textile LED panel

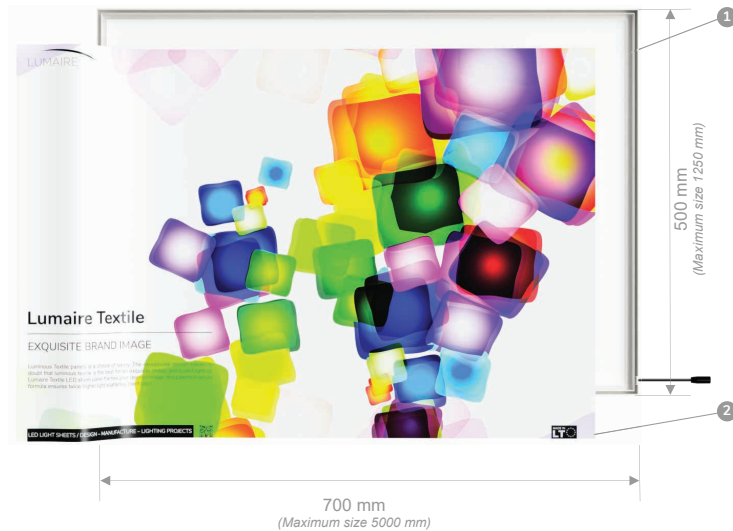

Lumaire Textile



SAMPLE KIT INCLUDE:

- 1• Sample Kit - Textile LED panel. Single sided. Dimensions: 500 x 700mm
- 2• Print - Textile included
- 3• Aluminium frame. Profile painted RAL9003 (White). Thickness is just 23mm
- 4• Power supply - white cable 1000mm
- 5• Power supply - DC 12V / 24V / CC Adaptor

Luminous Textile panels is a choice of luxury. The exceptional design leaves no doubt that luminous textile is the best for an exquisite image and brand lighting. Lumaire Textile LED sheet panel frames your desired image, the patent acrylic formula ensures twice higher light scattering coefficient.

SUPPORT 24/7, PROTECTION & WARRANTY

SAMPLE KIT Nr 3. Magnetic LED panel (*single sided*)

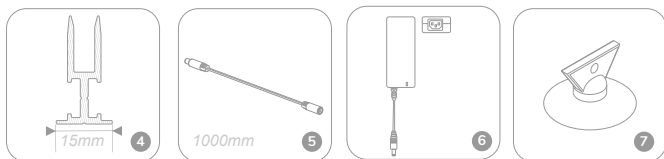

Lumaire Magnetic



Quick and easy print replacement

SAMPLE KIT INCLUDE:

- 1• Sample Kit - Magnetic LED panel. Single sided. Dimensions: 500 x 700mm
- 2• Print - Backlit included
- 3• Passe-partout. Narrow magnetic frame 19,5mm. Color: white
- 4• Aluminium frame. Thickness is just 15mm
- 5• Power supply - silver cable 1000mm
- 6• Power supply - DC 12V / 24V / CC Adaptor
- 7• Suction cup

One step, that's what you need to get your Lumaire Magnetic LED panel ready. The product is one of the most popular advertising solutions for a reason. The magnet inside the frame seals the sheets in a second. Unseal them even quicker. Place the suction cup on the surface and replace the backlit (the print image inside the panel) instantly as many times as you need for your advertising purposes.

SUPPORT 24/7, PROTECTION & WARRANTY

SAMPLE KIT Nr 4. Wayfinding LED panel

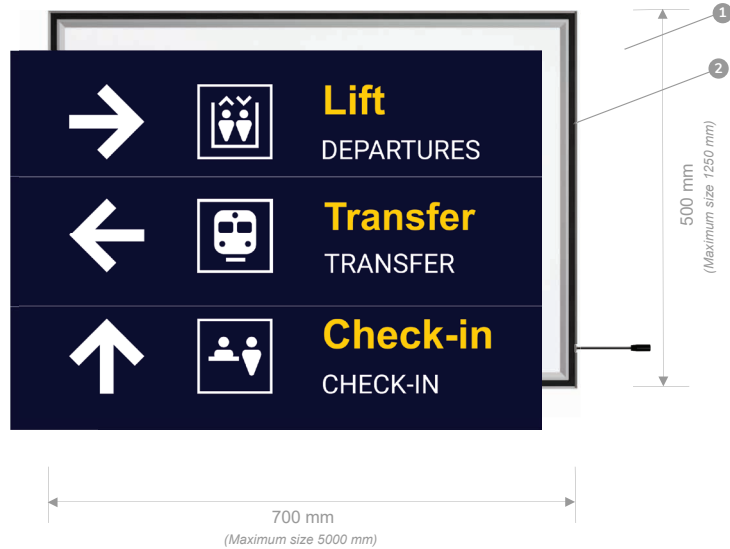

Lumaire Wayfinding



SAMPLE KIT INCLUDE:

- 1• Sample Kit - Magnetic LED panel. Single sided. Dimensions: 500 x 700mm
- 2• Print - PVC
- 3• Aluminium frame. Thickness is just 15mm
- 4• Power supply - silver cable 1000mm
- 5• Power supply - DC 12V / 24V / CC Adaptor

Lumaire Wayfinding is an opal acrylic light diffusing sheet with PVC print. The LED light panel is specifically suitable for directional sign lighting.

SUPPORT 24/7, PROTECTION & WARRANTY

SAMPLE KIT Nr 5. Magnetic LED pane (double sided)

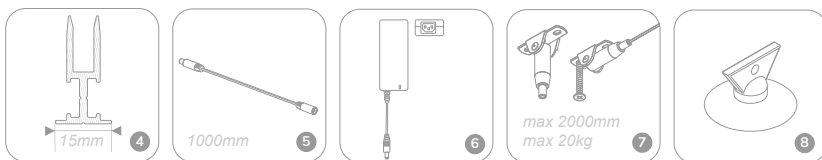

Lumaire Magnetic



Quick and easy print replacement



SAMPLE KIT INCLUDE:

- 1• Sample Kit - Magnetic LED panel. Double sided. Dimensions: 700 x 500mm
- 2• Print - Backlit included
- 3• Passe-partout. Standard magnetic frame 23,5mm. Color: black
- 4• Aluminium frame. Anodized black profile. Thickness is just 15mm
- 5• Power supply - black cable 1000mm
- 6• Power supply - DC 12V / 24V / CC Adaptor
- 7• Ceiling hanging kit
- 8• Suction cup

One step, that's what you need to get your Lumaire Magnetic LED panel ready. The product is one of the most popular advertising solutions for a reason. The magnet inside the frame seals the sheets in a second. Unseal them even quicker. Place the suction cup on the surface and replace the backlit (the print image inside the panel) instantly as many times as you need for your advertising purposes.

SUPPORT 24/7, PROTECTION & WARRANTY

TECHNICAL SPECIFICATIONS

Main material	Led Strip Power	Maximum size	Lifetime	Operating temperature	Color Temperature
Clear acrylic (PMMA)	15W/M	1250 x 2800 mm <i>Basic</i> 1250 x 5000 mm <i>Textile</i> 1250 x 2800 mm <i>Magnet</i> 1250 x 5000 mm <i>Wayfinding</i>	> 50,000 hours	-30°C ~ + 40°C	 3000 K  4000 K  5000 K  6500 K  CCT (Special order)  RGB (Special order)
IP RATING	Luminous efficiency	Power supply	Working voltage	Input voltage	
IP 20	up to 160lm/W	DC 12V / DC24V / CC Adaptor	DC 12V / DC 24V / CC	AC 100 ~ 240V 50/60Hz	

Lumaire Sample Kits

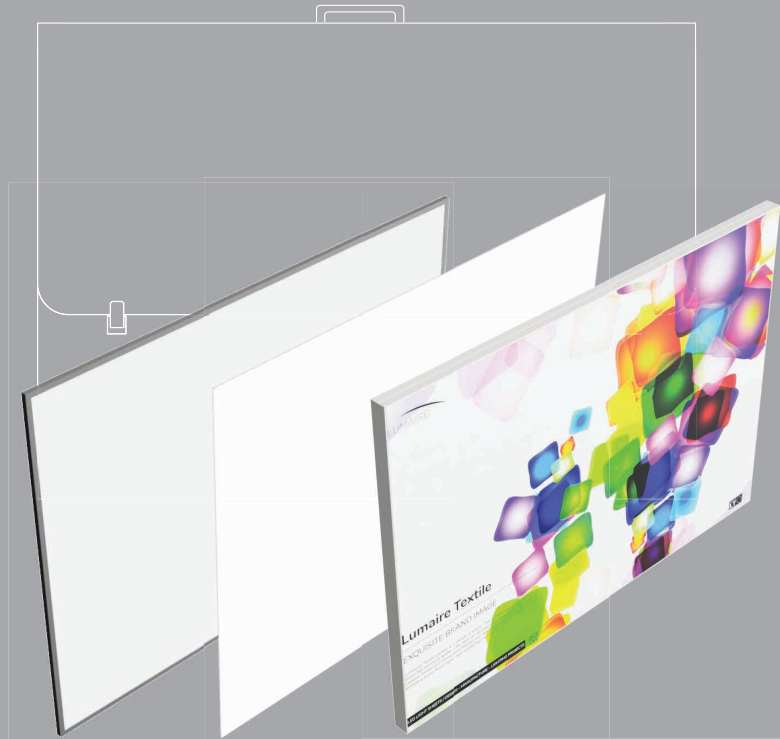

SAMPLE KIT Nr. 1.

Basic Led panel
700 x 500mm

Opal (Milky) front cover
700 x 500mm

SAMPLE KIT Nr. 2.

Textile Led panel
700 x 500mm



SAMPLE KIT Nr. 3.

Magnetic Led panel
700 x 500mm

SAMPLE KIT Nr. 4.

Wayfinding. Opal. PVC print
700 x 500mm

SAMPLE KIT Nr. 5.

Magnetic Led panel
500 x 700mm